

XIII - 1

OTOČNÉ PODPĚRNÉ ŠPIČKY



NTA s.r.o.
Komenského 365
763 16 Fryšták
www.nta.cz ntaoffice@nta.cz



XIII

REV02-111027

ODPRUŽENÁ OTOČNÁ ŠPIČKA

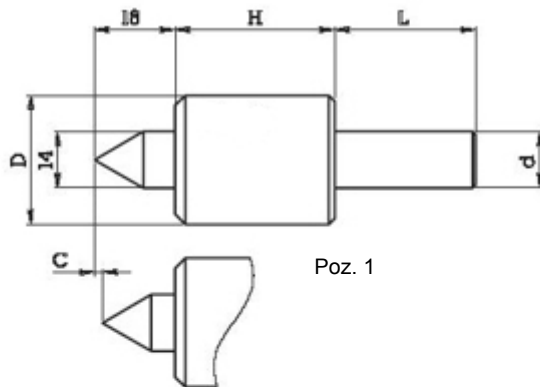

VÁLCOVÉ UPÍNACÍ PRŮMĚRY VŠECH NÁMI
DODÁVANÝCH ŠPIČEK JSOU VYRÁBĚNY V
TOLERANCI h7

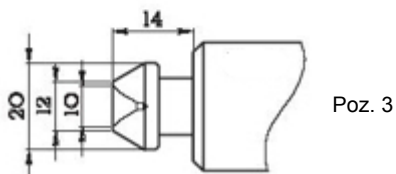
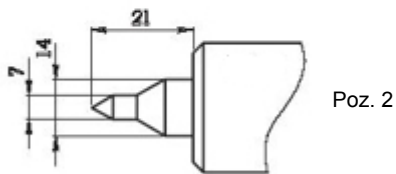

C - ZDVIH

| KOD | | | d | D | H | L | C | ÚHEL |
|------------|------------|------------|--------|----|------|----|---|------|
| POZ. 1 | POZ. 2 | POZ. 3 | | | | | | |
| 172.245 F1 | 172.208 F2 | 172.209 F3 | 8 | 32 | 39,5 | 35 | 2 | 60° |
| 172.210 F1 | 172.210 F2 | 172.210 F3 | 10 | 32 | 39,5 | 35 | 2 | 60° |
| 172.212 F1 | 172.212 F2 | 172.212 F3 | 12 | 32 | 39,5 | 35 | 2 | 60° |
| 172.214 F1 | 172.214 F2 | 172.214 F3 | 14 | 32 | 39,5 | 35 | 2 | 60° |
| 172.215 F1 | 172.215 F2 | 172.215 F3 | 15,675 | 32 | 39,5 | 35 | 2 | 60° |
| 172.216 F1 | 172.216 F2 | 172.216 F3 | 16 | 32 | 39,5 | 35 | 2 | 60° |
| 172.219 F1 | 172.219 F2 | 172.219 F3 | 19,05 | 32 | 19,5 | 46 | 2 | 60° |
| 172.220 F1 | 172.220 F2 | 172.220 F3 | 20 | 32 | 39,5 | 46 | 2 | 60° |
| 172.222 F1 | 172.222 F2 | 172.222 F3 | 22 | 32 | 39,5 | 46 | 2 | 60° |
| 172.225 F1 | 172.225 F2 | 172.225 F3 | 25 | 32 | 39,5 | 46 | 2 | 60° |
| 172.226 F1 | 172.225 F2 | 172.225 F3 | 25,40 | 32 | 39,5 | 46 | 2 | 60° |

ODPRUŽENÁ OTOČNÁ ŠPIČKA S VÝMĚNNÝM KUŽELOVÝM HROTEM

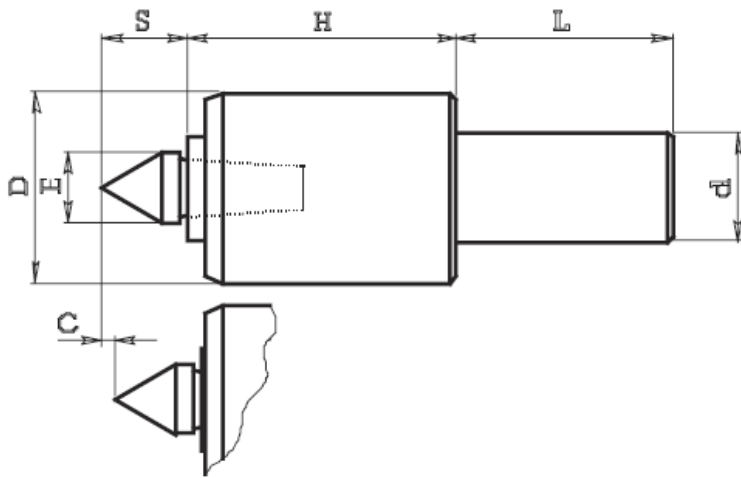

| KOD | d | D | E | H | L | S | C |
|---------|--------|----|----|----|----|----|---|
| 172.308 | 8 | 32 | 14 | 44 | 35 | 16 | 2 |
| 172.310 | 10 | 32 | 14 | 44 | 35 | 16 | 2 |
| 172.312 | 12 | 32 | 14 | 44 | 35 | 16 | 2 |
| 172.314 | 14 | 32 | 14 | 44 | 35 | 16 | 2 |
| 172.315 | 15,875 | 32 | 14 | 44 | 35 | 16 | 2 |
| 172.316 | 16 | 32 | 14 | 44 | 35 | 16 | 2 |
| 172.319 | 19,05 | 32 | 14 | 44 | 46 | 16 | 2 |
| 172.320 | 20 | 32 | 14 | 44 | 46 | 16 | 2 |
| 172.322 | 22 | 32 | 14 | 44 | 46 | 16 | 2 |
| 172.325 | 25 | 32 | 14 | 44 | 46 | 16 | 2 |
| 172.326 | 25,40 | 32 | 14 | 44 | 46 | 16 | 2 |

ŠPIČKA JE STANDARDNĚ DODÁVÁNA S HROTEM 172.301

VÝMĚNNÉ HROTY

| PRO ŠPIČKY TYPU 172.300 | | | | | | |
|-------------------------|------|----|----|----|----|------|
| KOD | Poz. | E | S | G | F | Uhel |
| 172.301 | 1 | 14 | 16 | - | - | 60° |
| 172.302 | 2 | 14 | 22 | 7 | - | 60° |
| 172.303 | 3 | 20 | 12 | 12 | 10 | 60° |

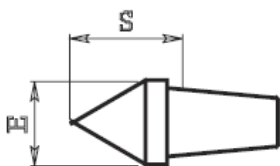
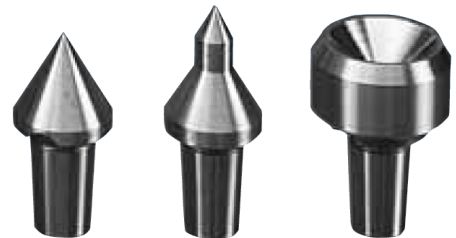

Poz. 1

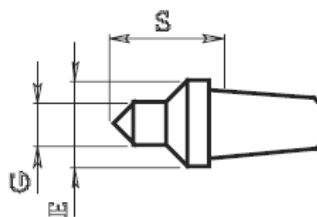

Poz. 2

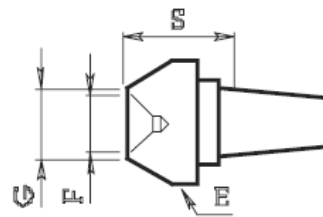

Poz. 3

ODPRUŽENÁ OTOČNÁ ŠPIČKA S VÝMĚNNÝM KUŽELOVÝM HROTEM

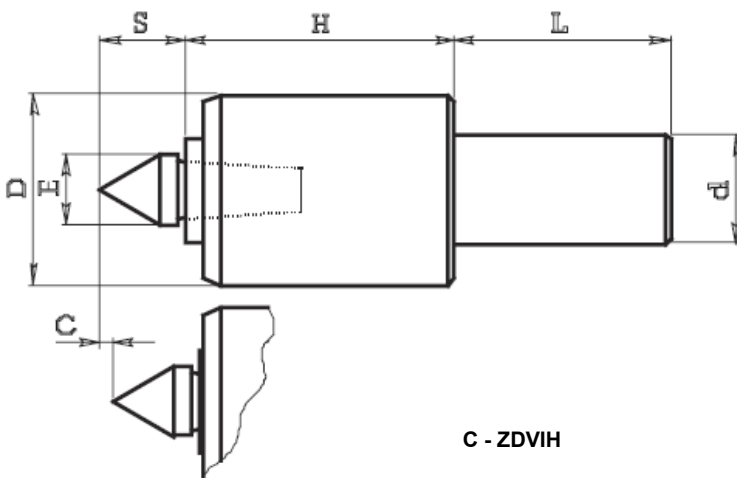

| KOD | d | D | E | H | L | S | C |
|-------------|---------|----|----|----|----|----|---|
| 172.419 | 19,05 | 43 | 18 | 43 | 46 | 21 | 3 |
| 172.420 | 20 | 43 | 18 | 43 | 46 | 21 | 3 |
| 172.422 | 22 | 43 | 18 | 43 | 46 | 21 | 3 |
| 172.425 | 25 | 43 | 18 | 43 | 46 | 21 | 3 |
| 172.426 | 25,40 | 43 | 18 | 43 | 46 | 21 | 3 |
| 172.430 | 30 | 43 | 18 | 43 | 46 | 21 | 3 |
| 172.431 | 31,75 | 43 | 18 | 43 | 46 | 21 | 3 |
| 172.432 | 32 | 43 | 18 | 43 | 46 | 21 | 3 |
| 172.400 CM2 | Morse 2 | 43 | 18 | 43 | 69 | 21 | 3 |
| 172.400 CM3 | Morse 3 | 43 | 18 | 43 | 85 | 21 | 3 |

KLÍČ PRO DEMONTÁŽ HROTU
KOD 172.411

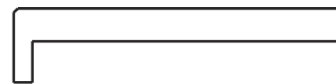

ŠPIČKA JE STANDARDNĚ DODÁVÁNA S HROTEM 172.401

VÝMĚNNÉ HROTY

| PRO ŠPIČKY TYPU 172.400 | | | | | |
|-------------------------|------|----|----|----|------|
| KOD | Poz. | E | S | G | Uhel |
| 172.401 | 1 | 18 | 21 | — | 60° |
| 172.401 090 | 1 | 18 | 28 | — | 90° |
| 172.402 | 2 | 18 | 27 | 7 | 60° |
| 172.402B | 2 | 18 | 38 | 9 | 60° |
| 172.403 | 3 | 30 | 21 | 14 | 60° |
| 172.404 | 4 | 26 | 20 | 20 | — |

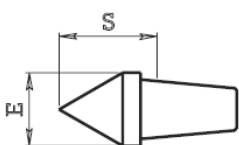
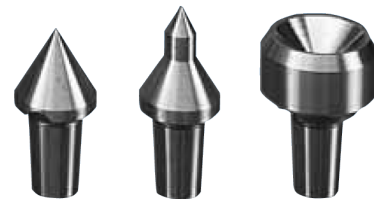

Poz. 1

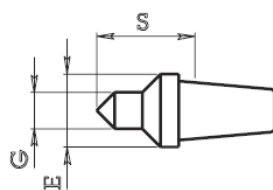

Poz. 2

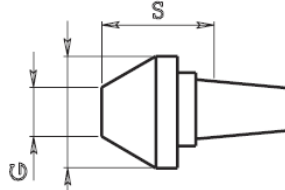

Poz. 3

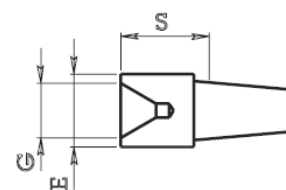

Poz. 4

ODPRUŽNÁ OTOČNÁ ŠPIČKA S VÝMĚNNÝM KUŽELOVÝM HROTEM

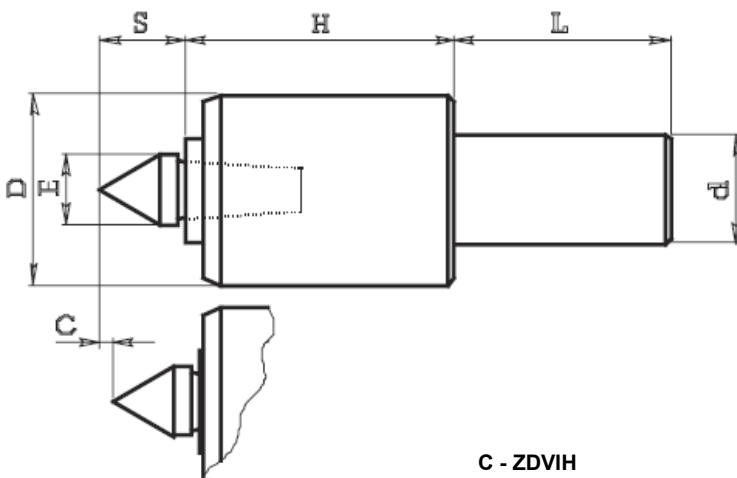

| KOD | d | D | E | H | L | S | C |
|-------------|---------|----|----|----|-----|----|-----|
| 172.625 | 25 | 58 | 28 | 71 | 50 | 34 | 2,5 |
| 172.626 | 25,40 | 58 | 28 | 71 | 50 | 34 | 2,5 |
| 172.632 | 32 | 58 | 28 | 71 | 70 | 34 | 2,5 |
| 172.640 | 40 | 58 | 28 | 71 | 85 | 34 | 2,5 |
| 172.600 CM3 | Morse 3 | 58 | 28 | 71 | 85 | 34 | 2,5 |
| 172.600 CM4 | Morse 4 | 58 | 28 | 71 | 109 | 34 | 2,5 |

KLÍČ PRO DEMONTÁŽ HROTU
KOD 172.411

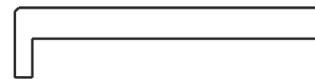

ŠPIČKA JE STANDARDNĚ DODÁVÁNA S HROTEM 172.601

VÝMĚNNÉ HROTY

| PRO ŠPIČKY TYPU 172.600 | | | | | |
|-------------------------|------|----|----|----|------|
| KOD | Poz. | E | S | G | Uhel |
| 172.601 | 1 | 28 | 34 | — | 60° |
| 172.602 | 2 | 28 | 40 | 7 | 60° |
| 172.602B | 2 | 28 | 40 | 12 | 60° |
| 172.603 | 3 | 58 | 36 | 25 | 60° |
| 172.604 | 4 | 28 | 32 | 24 | — |

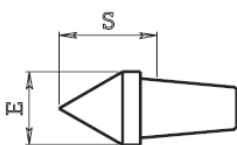

Poz. 1

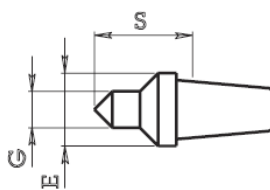

Poz. 2

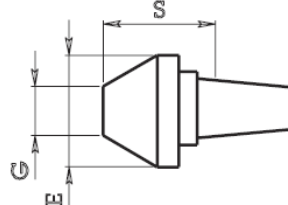

Poz. 3

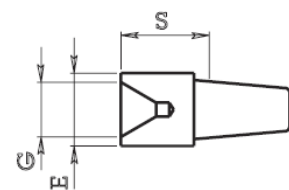

Poz. 4

ODPRUŽENÁ PODPĚRNÁ ŠPIČKA OTOČNÁ DIN 69880 (VDI 3425)

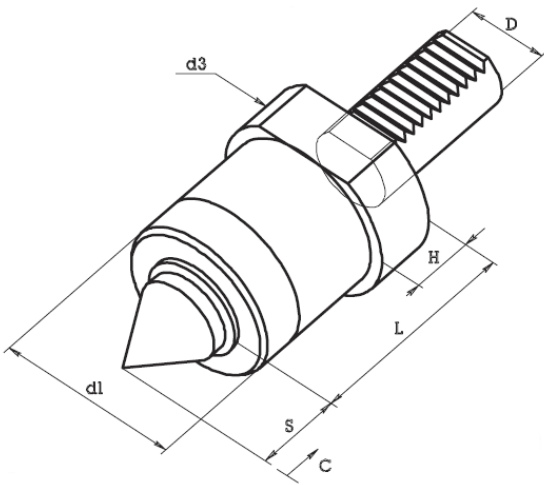

| KOD | D | d1 | d3 | L | H | S | C - zdvih |
|------------|----|----|----|----|----|----|-----------|
| 9 V3.30.78 | 30 | 58 | 68 | 78 | 20 | 34 | 2,5 |
| 9 V3.40.80 | 40 | 58 | 83 | 80 | 22 | 34 | 2,5 |

ŠPIČKA JE STANDARDNĚ DODÁVÁNA S HROTEM 172.601

VÝMĚNNÉ HROTY PRO ŠPIČKU VDI

| PRO ŠPIČKY TYPU 172.600 | | | | | |
|-------------------------|------|----|----|----|------|
| KOD | Poz. | E | S | G | Uhel |
| 172.601 | 1 | 28 | 34 | — | 60° |
| 172.602 | 2 | 28 | 40 | 7 | 60° |
| 172.602B | 2 | 28 | 40 | 12 | 60° |
| 172.603 | 3 | 58 | 36 | 25 | 60° |
| 172.604 | 4 | 28 | 32 | 24 | — |

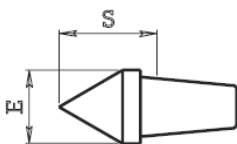

Poz. 1

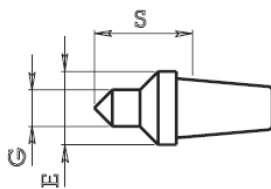

Poz. 2

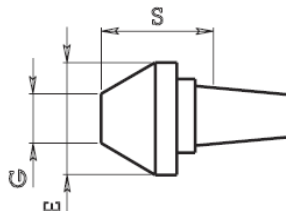

Poz. 3

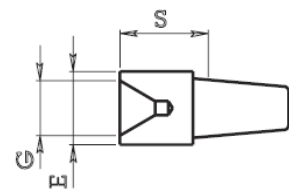

Poz. 4